

## AQD-ST6

### Modular photoreactor



- Available with FDA splitter protection
- Housing made of electropolished stainless steel (1.4301)
- Various cable length available due to M12 connector (stainless steel)

Product designation	AQD-ST6
Power supply	3x EBD
Material	Stainless steel 1.4301 / 1.4401, EPDM, PA 6, (Teflon)
UVC tube type	UVC 2036-4K (UVC 2036-4K(T))
UVC tube replacement interval	12'000 hours (75% ±5% residual capacity)
Connector	M12 straight or angled
Connector cable length	0.3 / 0.6 / 1.0 / 1.5 / 2.0 m
Classification	CE, EMC, FDA, (HACCP)
IP protection	IP 65

## AQD-ST6

### Modular photoreactor

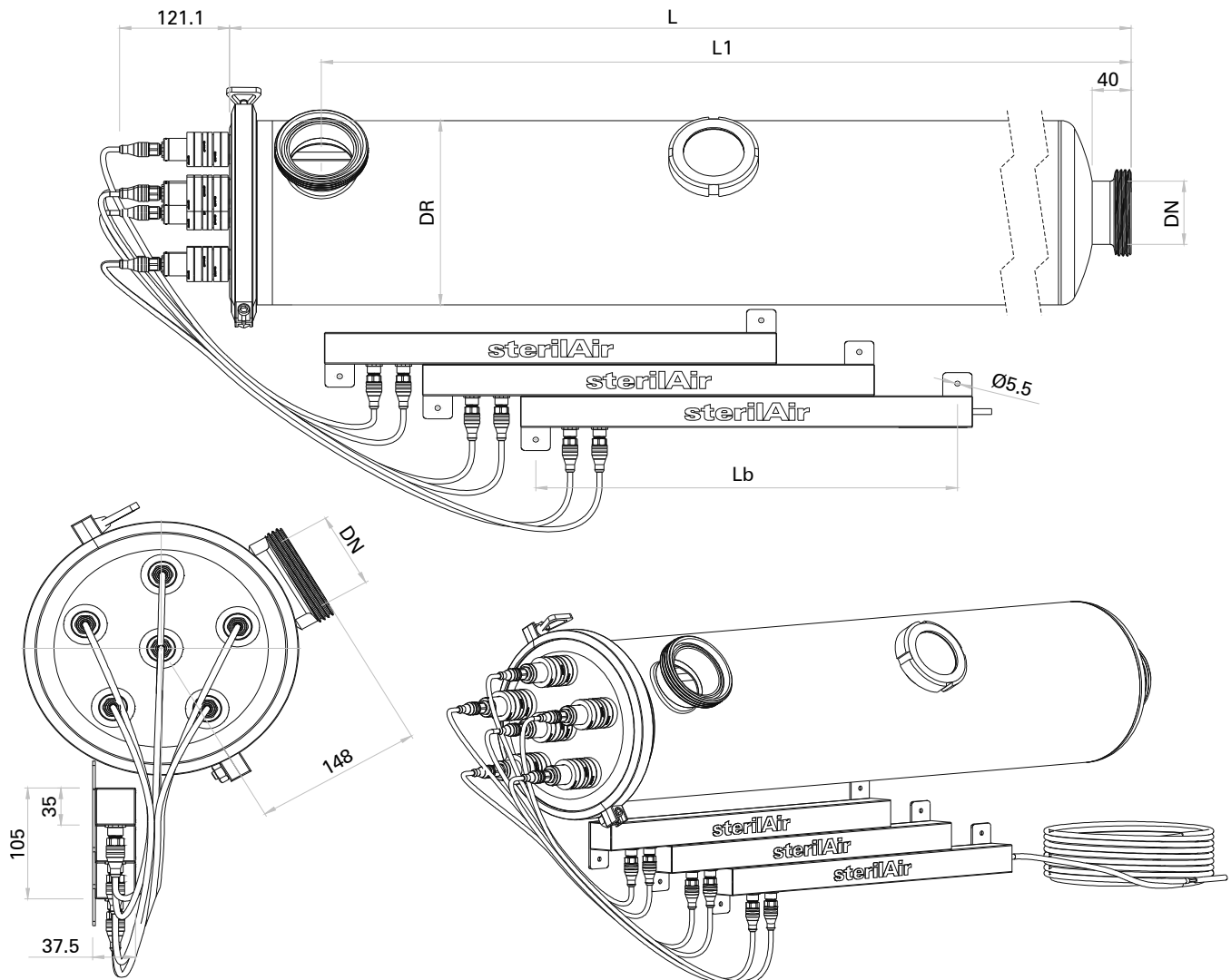

#### Product designation

#### AQD-ST6

Ø-reactor DR	Ø204
Length L	918 mm
Length L1	824 mm
Length Lb	430 mm
Dairy pipe connection DN	DN65 – Rd95x1/6" (DIN 11850)
Weight per unit (without EB)	23.40 kg